



EDEN MIDCALF  
— SALES & LETTINGS —

PCM

**£950 PCM**  
**The Stewponey**

Stourbridge, DY7 6RL



GROUND FLOOR  
350 sq.ft. (32.6 sq.m.) approx.

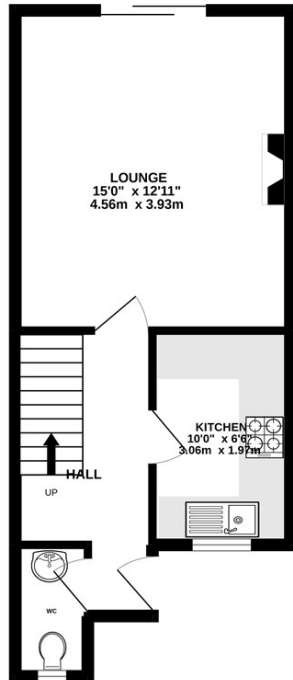

1ST FLOOR  
323 sq.ft. (30.0 sq.m.) approx.

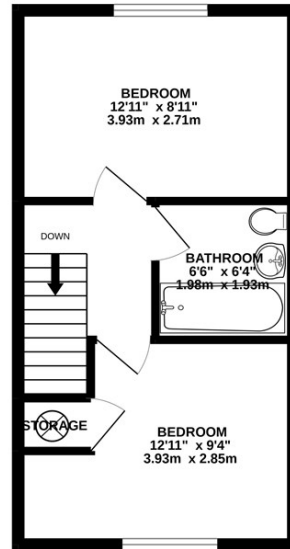

TOTAL FLOOR AREA: 673 sq.ft. (62.5 sq.m.) approx.

Whilst every attempt has been made to ensure the accuracy of the floorplan contained herein, measurements of doors, windows, rooms and any other items are approximate and no responsibility is taken for any error, omission or mis-statement. This plan is for illustrative purposes only and should be used as such by any prospective purchaser. The services, systems and appliances shown have not been tested and no guarantee as to their operability or efficiency can be given.  
Made with Mapbox ©2022



Energy Efficiency Rating		
	Current	Potential
Very energy efficient - lower running costs		
(92 plus) <b>A</b>		90
(81-91) <b>B</b>		
(69-80) <b>C</b>		
(55-68) <b>D</b>	70	
(39-54) <b>E</b>		
(21-38) <b>F</b>		
(1-20) <b>G</b>		
Not energy efficient - higher running costs		
<b>England &amp; Wales</b>	EU Directive 2002/91/EC	



Agents Note: Whilst every care has been taken to prepare these particulars, they are for guidance purposes only. All measurements are approximate and are for general guidance purposes only and whilst every care has been taken to ensure their accuracy, they should not be relied upon and potential buyers/tenants are advised to recheck

**EDEN MIDCALF**  
— SALES & LETTINGS —

42 Hagley Road  
Stourbridge  
West Midlands  
DY8 1QD

01384 443434  
lettings@edenmidcalf.co.uk  
<https://www.edenmidcalf.co.uk/>